

Measuring for your curtains is a piece of cake! No deductions, no calculations, we'll do all of that for you to make sure everything hangs perfectly. Follow our simple (and we mean simple) guide below for your type of track or pole and let us do the rest.

## Measuring the Width

Measure the curtain track or pole width, not the window width. It's important that this is the measurement provided, as we'll use your track or pole width to calculate the required amount of fabric for your curtains. If fitting a new track or pole, this should extend 15cm to 20cm either side of the window and at least 15cm above.

### Measuring for Poles

For a curtain pole simply measure the width of the pole between any finials or end caps, that is the width you should enter.

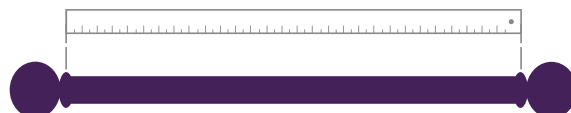

### Measuring for Tracks

For a standard curtain track simply measure the full width of the track, that is the width you should enter.

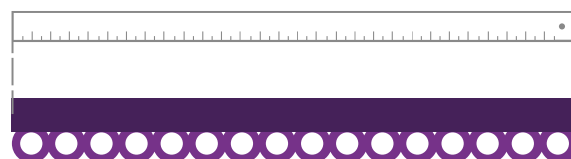

### Measuring for Tracks With Overlap

If your track has an overlap in the centre measure the full width of the track (a) and the width of the overlap (b). Add the two together and that is the width you should enter.

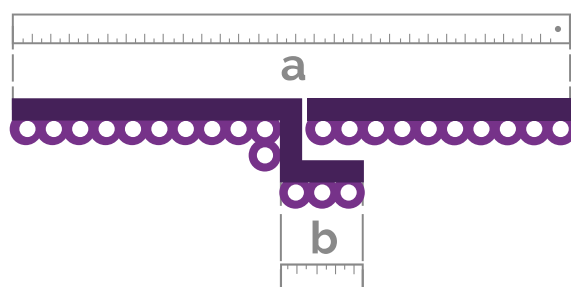

### Measuring the Drop

Curtains can be hung either to the floor, to the sill or to below the sill. We suggest that curtains finish either;

- 1.5cm above the floor
- 15-20cm below the sill (or 2 - 3cm above the radiator)
- 1.5 cm above the sill

#### Top-Tip:

It's important to allow a small amount of space at the bottom of the curtains; If they drag at the bottom then they could mark or fray.

### Pencil or Pinch Pleat Heading for a Pole

When using a curtain pole, measure from the underside of the decorative ring to where you want the curtain to finish at the bottom.

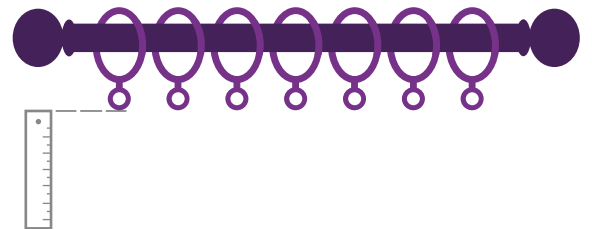

Alternatively, if you'd like the pole and decorative rings to be covered by the curtains, simply start your measurement from the top of the decorative rings instead.



### Pencil or Pinch Pleat Heading for a Track

When using a curtain track, measure from the top of the track to where the curtain is to finish at the bottom.



### Eyelet Heading for a Pole

Our eyelet heading curtains will fit poles up to 30mm in diameter. Simply measure from the top of the pole to where you want the curtain to finish at the bottom. We will make the curtain with 3cm of fabric above the top underside of the eyelet where it sits on the pole. **We add this automatically, so simply measure from the top of your curtain pole.**



## Standard Windows

If your windows are fairly standard, in that they aren't an unusual shape and are recessed into the wall, then you can measure either **inside the recess (recess fitting)**, or **outside of it (exact fitting)**. For our Wave curtains, we recommend exact fitting outside the recess.

### Exact fitting (recommended)

Measure the full width and height of the recess [the size of the hole if you like] and add a little extra to the top and to each side, we'll make the Wave curtains to the size you specify with no deductions.

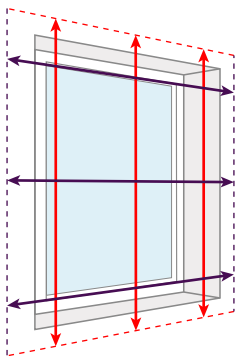

- To minimize light leakage **we recommend that the Wave curtains overlap the window recess by at least 150mm at the top and on each side**
- The overlap at the bottom is a matter of personal choice but please **take into account obstacles** such as radiators

#### Top-Tip:

If you are **replacing existing curtains** and you want the same size, simply measure the width of the pole or track, and the drop from the top of the pole or track to the bottom of the curtains, and specify exact fitting, we will make your Wave curtains the same size overall (we will send the track with your Wave curtains, so the track will be included in the size).

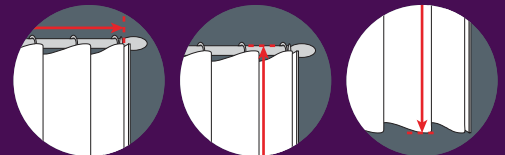

### Recess fitting

Measure the full width and height of the recess [the size of the hole if you like] and we will make the appropriate deductions to ensure a perfect fit.

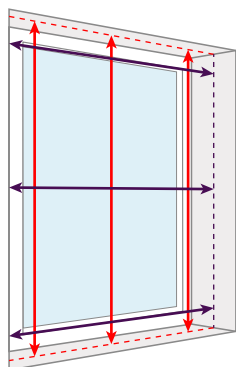

- **Measure in 3 places** for both the width and the drop, **use the smallest measurement**
- **Don't make any deductions**, we'll deduct 10mm from the width and 15mm from the drop to ensure your Wave curtains fit perfectly
- **Use a metal tape measure**, cloth ones can stretch and give you inaccurate measurements

#### Top-Tip:

Check that your recess is deep enough to fit the Wave curtains into, also bearing in mind any obstructions such as handles.

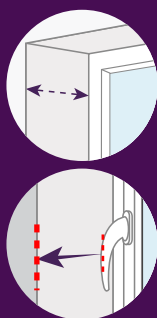

Depth Needed for Wave Curtains  
75mm

## Other Windows

### Part-tiled recesses

If you have tiles part-way up your recess (often the case in kitchens and bathrooms) then the space between them is most likely to be the narrowest point in the recess.

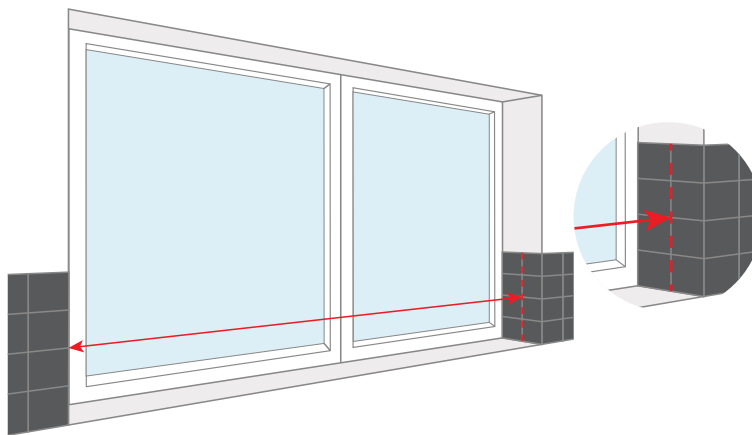

**Measure between the tiles** to ensure your Wave curtains will fit.

#### Top-Tip:

Do the same if you have a picture rail, skirting board or other items on the inside of the recess.

### Bay windows, half-bays & L-shaped windows

We recommend for these windows that you fit the Wave curtains onto the wall outside the bay covering the whole space in one run. Refer back to our 'exact fitting' advice at the top of this page.

